

# User Manual

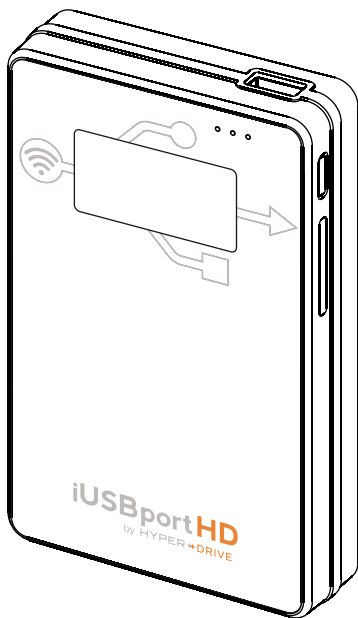

[www.hyperdrive.com](http://www.hyperdrive.com)



# FCC STATEMENT

1. This device complies with Part 15 of the FCC Rules.

Operation is subject to the following two conditions:

(1) This device may not cause harmful interference.

(2) This device must accept any interference received, including interference that may cause undesirable operation.

2. Changes or modifications not expressly approved by the party responsible for compliance could void the user's authority to operate the equipment.

NOTE: This equipment has been tested and found to comply with the limits for a Class B digital device, pursuant to Part 15 of the FCC Rules. These limits are designed to provide reasonable protection against harmful interference in a residential installation.

This equipment generates, uses and can radiate radio frequency energy and, if not installed and used in accordance with these instructions, may cause harmful interference to radio communications. However, there is no guarantee that interference will not occur in a particular installation. If this equipment does cause harmful interference to radio or television reception, which can be determined by turning the equipment off and on, the user is encouraged to try to correct the interference by one or more of the following measures:

- Reorientate or relocate the receiving antenna.

- Increase the separation between the equipment and receiver.

- Connect the equipment into an outlet on a circuit different from that to which the receiver is connected.

- Consult the dealer or an experienced radio/TV technician for help.

RF warning statement:

The device has been evaluated to meet general RF exposure requirement. The device can be used in portable exposure condition without restriction.

# Sanho Manufacturer's Limited Warranty

Sanho warrants to the end user, that this product, excluding content and/or software supplied with or on the product, will be free from material defects in manufacture, will conform to Sanho's published product specifications, and will be fit for normal use during the Warranty Period specified below commencing on the date of purchase, provided that the product is legally placed on the market.

To make a warranty claim please contact Sanho at the telephone number below or e-mail [support@hypershop.com](mailto:support@hypershop.com) within the Warranty Period and provide proof of purchase (showing date and place of purchase and name of the reseller) and product name, type and number. You may return the product after first obtaining a Return Material Authorization number and following any other guidelines listed. For further information see [www.hypershop.com](http://www.hypershop.com). Sanho may at its option repair this product or provide you with an equivalent product; and if unable to repair or replace the product, will refund the purchase price. Sanho will not be liable for indirect or consequential damage (including loss of data), or for damage caused by improper use (including use in an incompatible device and use not in accordance with the instructions), or by improper installation, unprofessional repair, modification or accident. This constitutes Sanho's entire liability which will never exceed the price you paid for it, plus the necessary costs you made for the warranty claim. Sanho products must not be used in applications where failure could threaten injury or life, such as life support systems. National, state and local laws may grant you other rights that are not affected by this warranty.

Warranty Period: 1 Year

Sanho Corporation  
47456 Fremont Blvd.  
Fremont, CA 94538, U.S.A.  
Tel: +1-408-737-7878

Additional terms and conditions can be found at [www.hypershop.com](http://www.hypershop.com)  
Usage of this product constitutes acceptance of these terms and conditions.

# Content

What's In The Box

Battery Charging

USB Connection to PC

Using iUSBport As USB Charger

Using iUSBport As Wireless Storage

Accessing iUSBportHD Storage

Before Unplugging USB Mass Storage Device

Normal Shutdown

Changing SSID & Password

Connecting iUSBport to an Existing WiFi Network

View Hard Drive S.M.A.R.T. Info

Options of iUSBportHD

Accessing iUSBportHD in Mac OS

Accessing iUSBportHD in Windows

Standard Network Service List

Copying Memory Card to iUSBportHD

Upgrading the Firmware

Specification

# What's In The Box

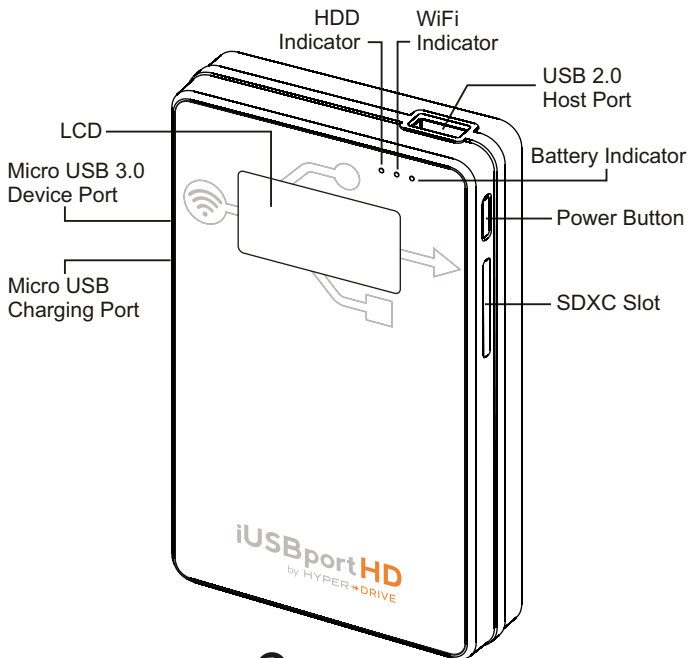

**1** Main Unit



**2** This User Manual

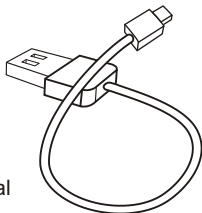

**3** Micro USB Charging Cable

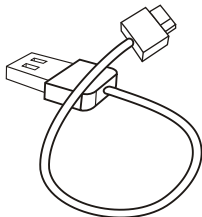

**4** USB 3.0 Cable

# Battery Charging

The product package does not include a USB charger. We recommend that you use a tablet (e.g. iPad) USB charger (5V/2.1A) to charge the battery.

The battery indicator will light up orange during charging. When the battery is fully charged, the battery indicator will turn green. (~6hrs to full charge from empty)

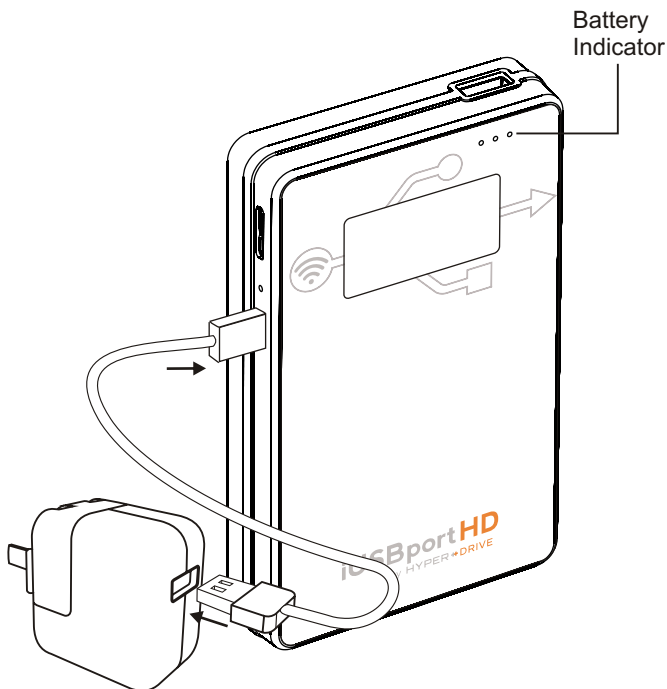

USB Charger

(This accessory is not included in the product package.)

# USB Connection to PC

Turn off iUSBportHD before connecting it to a computer via USB.

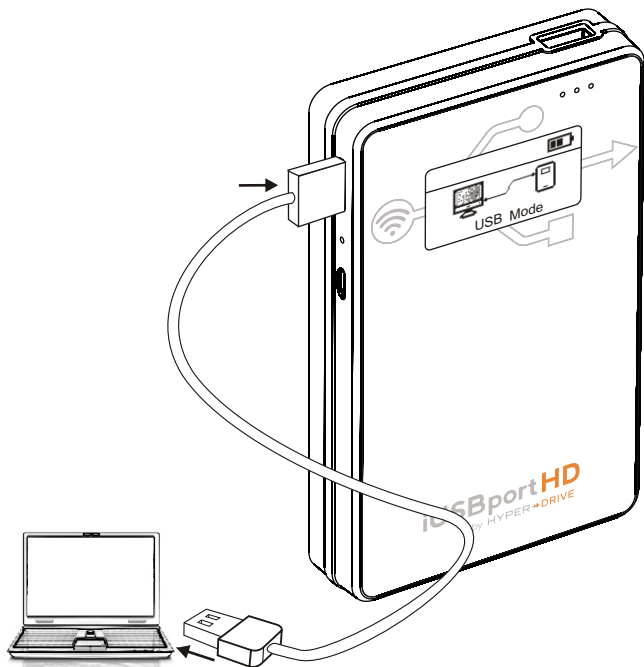

We recommend using the USB cable provided with iUSBportHD.

## Tip

The computer would not detect the iUSBportHD if it is turned on.



# Using iUSBport As USB Charger

iUSBport is able to function as a USB charger for a wide range of mobile devices. It outputs 5V, 1A from its USB port, allowing it to charge one USB device like smartphone.

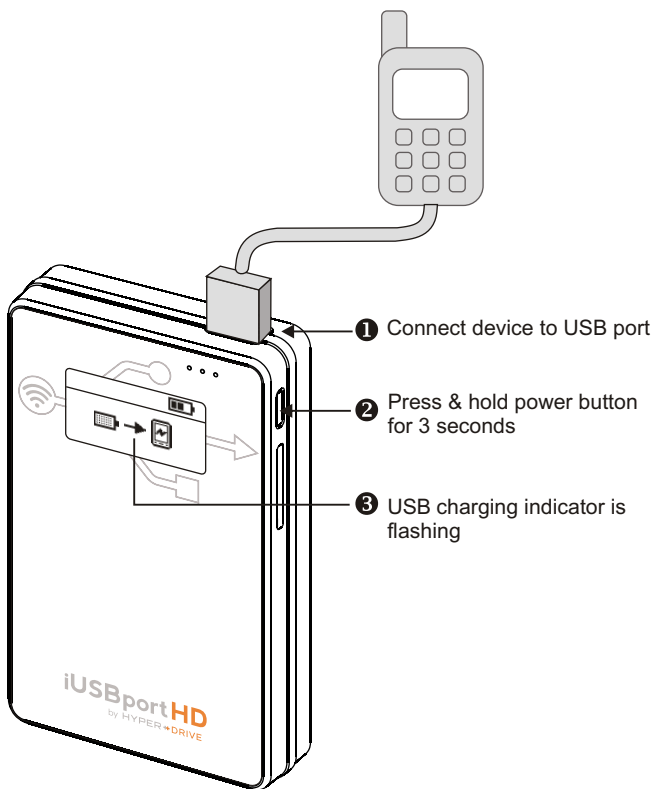

**4 When done press power button again to turn off iUSBport**

# Using iUSBport As Wireless Storage

- 1 Press power button and release it when the LCD lights up.

Connect device to USB port

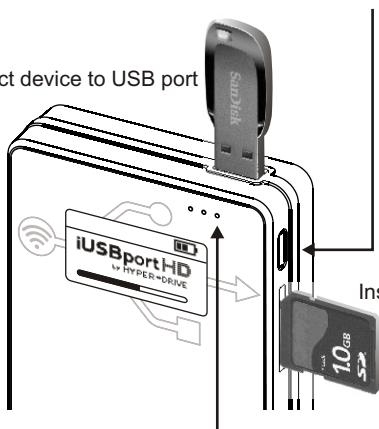

Insert the SDXC card

- 2 Wait for 30 seconds until WiFi indicator is flashing.
- 3 LCD displays all system information.

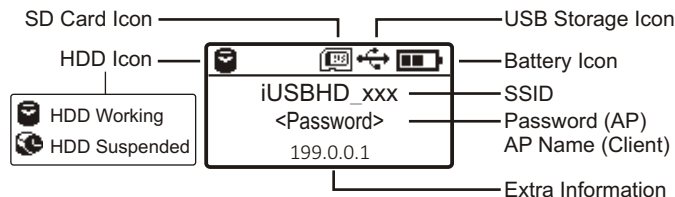

- 4 Go to "Settings" in your WiFi device (e.g. iPad, iPhone)
- 5 Select from the list of WiFi networks.



# Accessing iUSBportHD Storage

- 1 Select "Safari" or any web browser on the WiFi device (e.g. iPad, iPhone)



- 2 Enter '<http://199.0.0.1>' in the URL address bar of the web browser.

The contents of the USB device will be displayed in the browser.

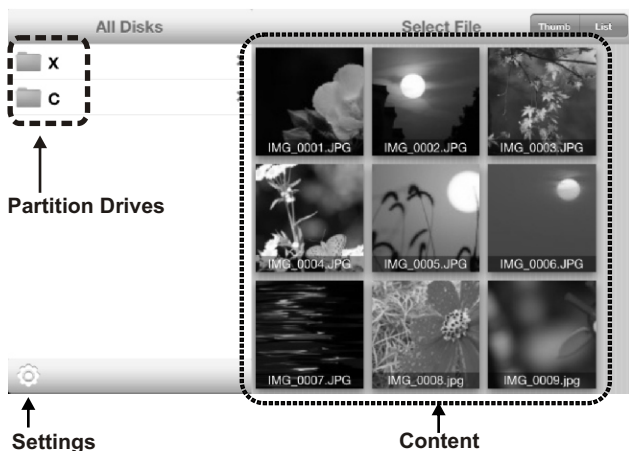

## Tip

We recommend using Safari or Chrome browser as much as possible. Other browsers may not be able to display the full user interface.

Native iUSBport iPhone, iPad and Android apps are also available to provide additional file management features.

## Before Unplugging USB Mass Storage Device

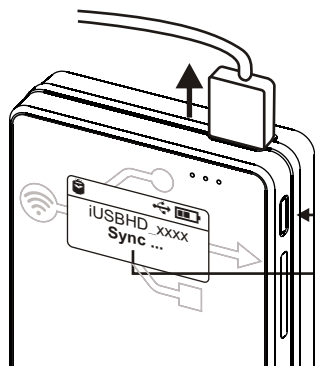

- ① Press power button
- ② LCD will display "Sync ..."
- ③ Wait for Sync to complete and then unplug USB device from iUSBportHD



**Do not unplug device during device shutdown**

## (Alternate Method) Remote Unload USB

- ① Click "Setting" icon

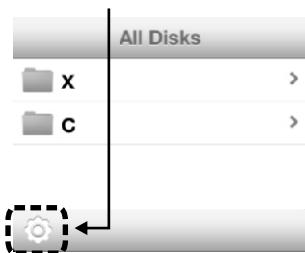

- ② Tap "Unload:" in setup page



## Normal Shutdown

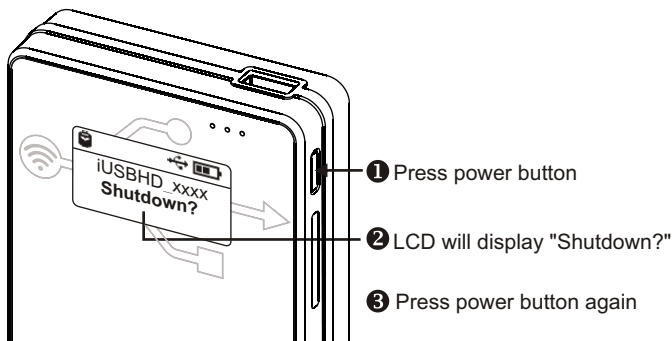

- 4 iUSBportHD will calculate free disk space and display it on the LCD.

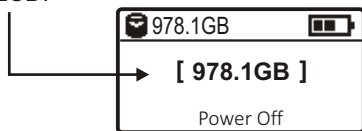

iUSBportHD can keep the latest display on the LCD after power off.

## Force Shutdown

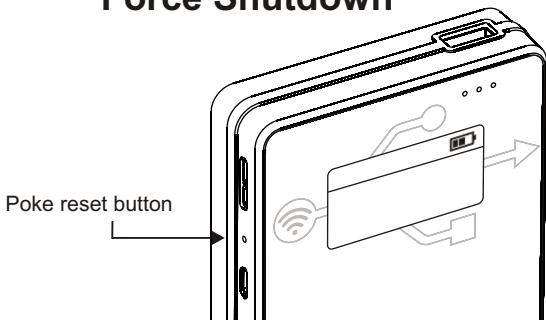

# Changing SSID & Password

Remember to change the default SSID password. Otherwise, unauthorized users will be able to access your iUSBport and its data.

- 1 Click "Setting" icon and tap "SSID:" in setup page

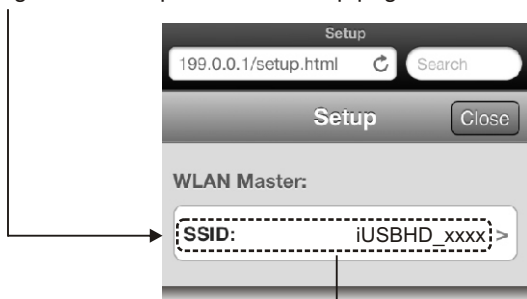

- 2 Input new SSID & password:

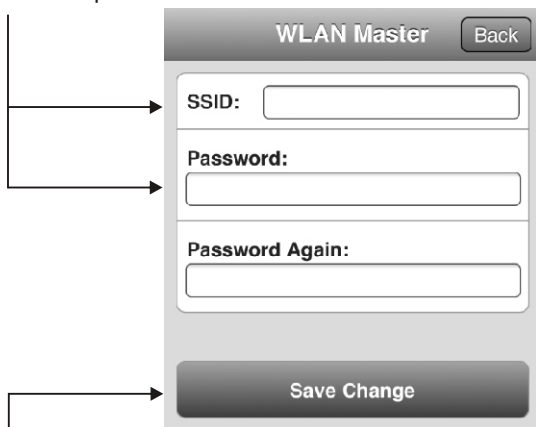

- 3 Tap "Save Change" and reboot iUSBport.

# Connecting iUSBport to an Existing WiFi network

If you want your mobile device (e.g. iPad, iPhone, smartphone, tablet, computer etc.) to access iUSBport and the Internet at the same time, you will need to connect iUSBport to an existing WiFi network. This mode is called "Infrastructure Mode". In this mode, you can access iUSBport with your mobile device and remain connected to the Internet at the same time.

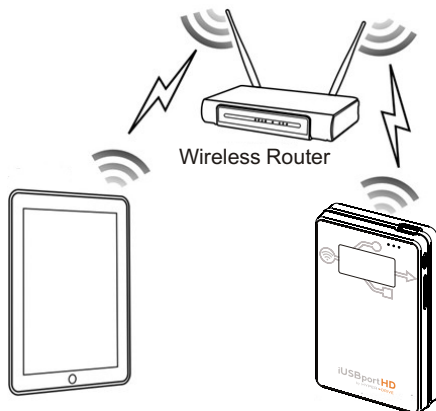

- ❶ Tap "SSID:" in "WLAN Station:" section of setup page

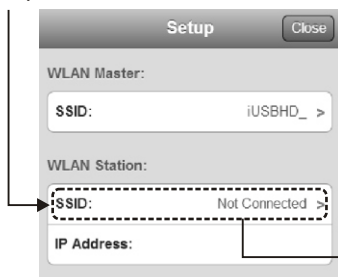

- ❷ Choose a WLAN in WLAN list

- ❸ Enter the network password, then click 'Ok' to save the password.

# View Hard Drive Info

- ① Click "Setting" icon and hard drive info is shown in setup page. →

Calculate free disk space during power off

## Hard Drive:

Model: HGST HTS541010A9E680

Serial: JD100019K86P1M

Capacity: 1.00 TB

Check Disk Space: ☒

Enable File Caching: ☒

Self-Monitoring: Available >

Cache video file into internal SSD while iUSBportHD is streaming video. When video file was cached, HDD will be suspended to save power.

- ② Tap "Self-Monitoring" to view hard drive S.M.A.R.T info

## Tip

**S.M.A.R.T** stands for **Self-Monitoring, Analysis and Reporting Technology**. This feature detects and records any foreseeable mechanical failures of the hard drive, and warns of any failure that may result in data loss.

## S.M.A.R.T. Info

Close

Raw\_Read\_Error\_Rate: 0

Spin\_Up\_Time: 1

Start\_Stop\_Count: 550

Reallocated\_Sector\_Ct: 0

Seek\_Error\_Rate: 0

Power\_On\_Hours: 99

Spin\_Retry\_Count: 0

Calibration\_Retry\_Count:

Power\_Cycle\_Count: 529

Power-Off\_Retract\_Count: 90

Load\_Cycle\_Count: 2930



# Options of iUSBportHD

- ❶ Click "Setting" icon and options is shown in setup page.

- ❷ "Enable HFS+ Writing" option used to remove journal from a HFS+ file system. So that you can upload files into a HFS+ storage device.

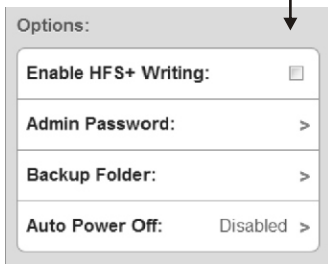

The screenshot shows a grey box titled "Options:". Inside, there are four rows, each with a label and a control element:

Options:	
Enable HFS+ Writing:	<input type="checkbox"/>
Admin Password:	>
Backup Folder:	>
Auto Power Off:	Disabled >

- ❸ "Admin Password" option allows you to setup a password to prevent unauthorized accessing setup page.

NOTE: If you forgot password, you must reset iUSBportHD to default setting. Create a blank file named 'clear\_my\_iusbport\_password' in a USB flash. Insert that USB flash into iUSBportHD's USB port. Wait for a while until LCD display "Reset To Default".

- ❹ "Backup Folder" option allows you to specify a folder that is used to save imported files. If this optional is blank, all imported files will be placed at root folder.

Tap "Backup Folder" and input folder name. Note: iUSBportHD will create this folder in root folder of the 1st FAT32 partition.

- ❺ "Auto Power Off" option allows you to enable auto-power off function.

Tap "Auto Power Off" and input power off interval. iUSBportHD will turn off if there is no network accessing for specified interval.

# Accessing iUSBport in Mac OS

- 1 In the Finder Window, select 'Connect to Server' from the 'Go' menu.

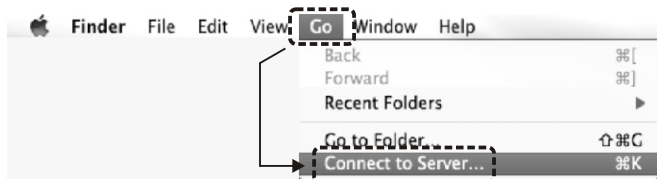

- 2 Enter the IP address of iUSBport (in the format smb://<IP address>) in the 'Server Address' text box.  
The IP address is 199.0.0.1 by default or displayed on the iUSBport LCD screen.

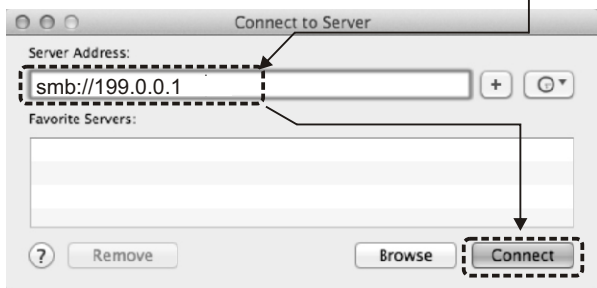

- 3 Select 'Guest' and 'Connect'.



# Accessing iUSBport in Windows

- 1 Open 'My Computer' ;  
Enter the IP address of iUSBport in the address bar;



My Computer

**NOTE! Add two backslashes before the IP address!**

The IP address is 199.0.0.1 by default or displayed on the iUSBport LCD screen.

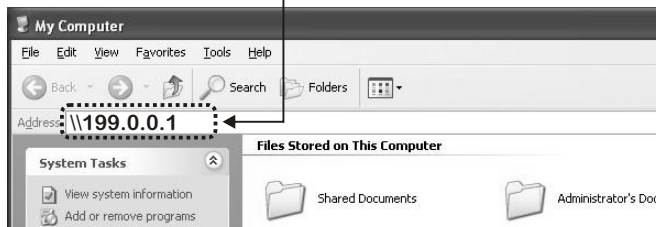

- 2 Click 'Go' or press Enter on the keyboard, and the iUSBport drive will show on the window.

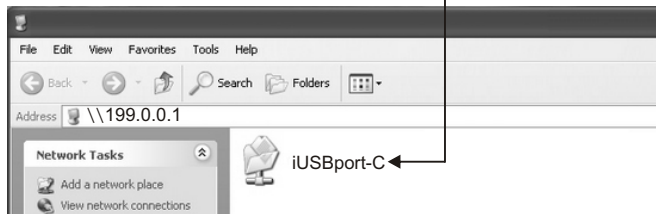

- 3 Click 'iUSBport' to access the contents of iUSBportHD.

# Standard Network Service List

There are several standard network servers in iUSBportHD, such as FTP, DLNA, WebDAV and Samba servers. iUSBportHD can be accessed by standard FTP, DNLA, WebDAV or Samba client apps or software. FTP and Samba servers support read and write operation if the storage device is 'FAT32', 'exFAT' or 'NTFS' formatted .

---

## FTP Settings

FTP server IP address: **199.0.0.1** ('Access Point' mode)  
(In 'Infrastructure' mode, use IP address that is shown on iUSBport LCD)  
FTP server TCP/IP port number: **21**  
FTP server user name: **anonymous**  
FTP server password: **<none>**

## Samba Settings

Samba server IP address: **199.0.0.1** ('Access Point' mode)  
(In 'Infrastructure' mode, use IP address that is shown on iUSBport LCD)  
Samba server TCP/IP port number: **139**  
Samba server user name: **Guest**  
Samba server password: **<none>**

## WebDav Settings

Samba server IP address: **http://199.0.0.1:81/webdav** ('Access Point' mode)  
(In 'Infrastructure' mode, use IP address that is shown on iUSBport LCD)  
WebDAV server user name: **<none>**  
WebDAV server password: **<none>**

---

In iUSBport's setup page, you can enable/disable these network services.

### Note:

**If FTP server was disabled, you cannot upload files into iUSBport anymore.**

#### Network Services:

Enable FTP:	<input checked="" type="checkbox"/>
Enable Samba:	<input checked="" type="checkbox"/>
Enable DLNA:	<input checked="" type="checkbox"/>
Enable WebDAV:	<input checked="" type="checkbox"/>

# Copying Memory Card to iUSBportHD

iUSBportHD can copy memory card from a USB card reader or SD card slot to internal hard disk drive (FAT32 formatted). All files including photos and videos can be transferred into the iUSBportHD automatically.

- 1 Connect USB card reader with memory card to iUSBportHD. Or insert SD/SDHC/SDXC card into iUSBportHD. If you insert two memory card into iUSBportHD, it will not copy those cards automatically.

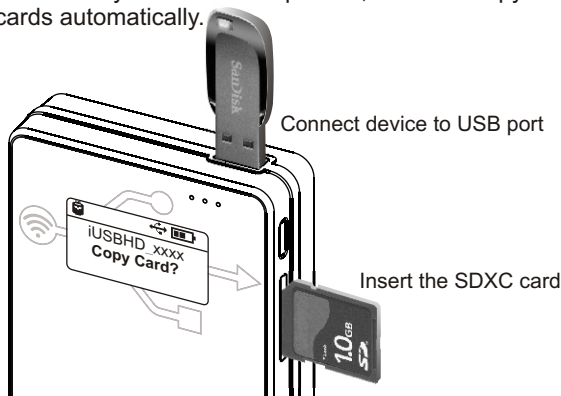

- 2 When LCD displays "Copy Card?", press power button once.

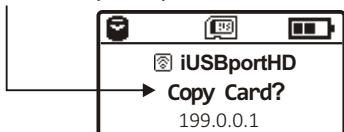

- 3 iUSBportHD will copy memory card to internal HDD
- 4 After successful copy, iUSBport will turn itself off. Otherwise, the error message will be displayed on LCD for about one hour.

**Tip** The FAT32 file system is required for internal HDD to perform copy operation.

# Upgrading the Firmware

The firmware of iUSBport can be upgraded to add new features and to address any software bugs.

- ❶ Download firmware which should be named IUSBHD.SEF
- ❷ Copy IUSBHD.SEF to the root folder of USB storage device.
- ❸ Insert this USB storage device into iUSBport, and it will display the following update message:

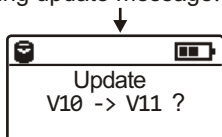

- ❹ Press power button once to start updating.

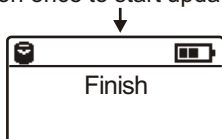

Update successful

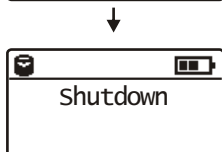

System will power off

# Specification

Model:	iUSBportHD
USB Port:	USB2.0 High Speed 480MBps x 1 USB3.0 Super Speed 5GBps x 1
Card Slot:	SD/SDHC/SDXC Slot x 1
Internal Flash:	8GB
Wireless:	WiFi 802.11b/g/n
LCD:	Mono STN 132*64 with backlight
Charging Rate:	DC 5V 1A ~ 2A
Battery:	3850mAh Li-Poly
Standard Accessories :	Micro USB Charging Cable x 1 USB3.0 Device Cable x 1 User Manual x 1
Wireless Mode:	Access Point Mode Infrastructure Mode
Network Service:	Web Server with extension FTP Server Samba Server DLNA Server WebDAV Server
Compatible With:	iPad/iPhone/Android/WiFi Devices USB Mass Storage Compliant Devices

# iUSBportHD

Designed in Silicon Valley, California by Sanho Corporation  
All rights reserved. Copyright 2013.

Apple, iPad, iPhone are registered trademarks of Apple, Inc.  
All other trademarks are copyrights are the property of their  
respective owners