



## USER GUIDELINE

Thank you for choosing MOON headlight!

\*For using this product safely and conveniently and keeping it well-preserved, please read this manual carefully before using. Please save this manual for future reference.

\*Due to the improvement of the product, the product you bought may not be exactly in accordance with the introduction of this manual. We apologize for that.

### SPECIFICATION

- \*1 pc CREE XP-G2 (R5) high brightness LED
- \*Rechargeable lithium polymer battery (3.7V 1200mAh)
- \*USB rechargeable
- \*Water resistant (IPX 4)
- \*Headlight with durable aluminum alloy light cap
- \*6 modes: Over drive / High / Standard / Flashing / Strobe / SOS
- \*Quick release handlebar mount (fits 22-31.8mm)
- \*Quick release helmet mount
- \*Low battery, charging and fully charged indicator
- \*Mode status indicator
- \*Automatic fully charged cut-off system
- \*High precision optical lens

### CONTENTS INCLUDED



#### Contents:

- \*Meteor 250
- \* USB-01 (USB cable)
- \* RB-07 (Handlebar bracket)

#### Optional accessories:

- \* XP-USC (Wall charger)
- \* RB-06 (Helmet mount bracket)

### HEADLIGHT OPERATION

1. Please make sure that there are no obstacles around the headlight to keep the air flow smoothly, as the light will get hot during use. Please don't touch the light immediately after a long time use.

2. Press the power button to choose the modes:

In this method three modes are cycled.

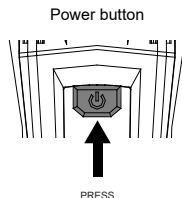
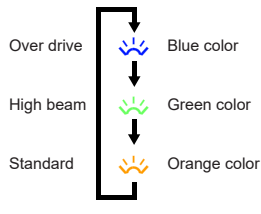

3. Fast press two times the power button to change into the strobe and flashing modes. Fast press two times back to the first cycle.

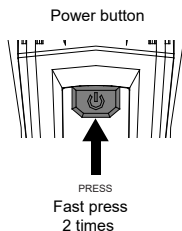

4. Press the power button to choose the modes again :

In this method three modes are cycled also.

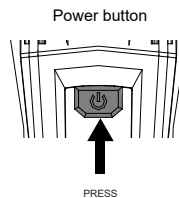
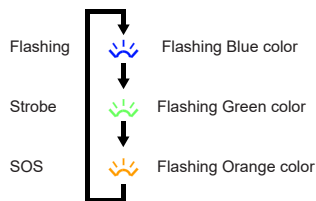

Never use the SOS sign unless there is a real emergency or danger occurring. The SOS signal is visible for several miles, thanks to the high light output of the lamp. And the battery can support for long runtime up to several hours.

5. Press and hold the on / off button around 0.5 seconds to turn off.

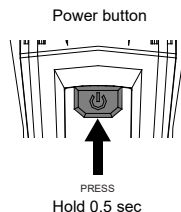

6. Battery power indicator: 100% -60% blue color, 60 % - 20% yellow color, 20 % - 0 % red color. During charging it turns flashing blue and when fully charged it turns steady blue.

7. When the battery indicator turns flashing red, it means the battery is low. You'd better charge the light right now.

Battery indicator

- \* 100%-60% Blue
- \* 60%-20% Green
- \* 20%-0 % Flashing Red

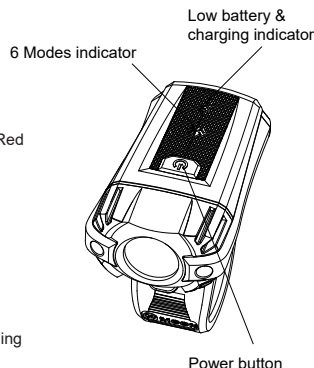

Charging indicator

- \* Flashing blue - charging
- \* Solid blue - charged

### HOW TO MOUNT THE HEADLIGHT

1. Install the bracket onto handlebar by wrapping rubber strap around post/bar and stretching strap around hook to secure.
2. Slide headlight forward onto bracket until it clicks into place.
3. Press down release lever to remove.

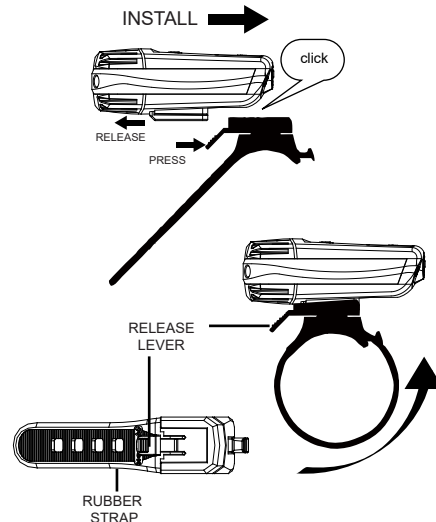

### HOW TO MOUNT THE HEADLIGHT TO HELMET

1. Wrap belt around helmet and return the belt onto slotted space.
2. Twist screw knob clockwise until tight.
3. Slide headlight forward onto bracket until it clicks into place.
4. Press down release lever to remove.

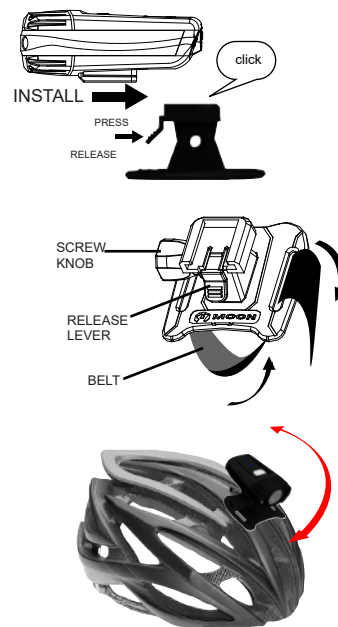

To adjust the vertical beam angle when mounted on the helmet, loosen the screw knob and rotate the light up or down to your preferred angle, then tighten the screw knob to secure the light in place.

## BEAM ADJUSTMENT

To adjust the horizontal beam, spin the headlight left to right for your best side to side beam angle. To adjust the vertical beam angle, loosen the mounting and rotate the light up and down to your best vertical beam angle, then tighten the mounting.

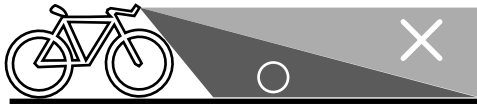

The beam is widely dispersed, besides its high brightness. To prevent from blinding the oncoming vehicles on the public roads, you'd better adjust the angle downward.

## HOW TO CLEAN AND CARE THE LIGHT

\*Make sure to clean the dust and dirt on the light with soft damp cloth after every ride.

\*Water resistant is for rain water only. Do not submerge the battery or the whole light into water when cleaning.

\*Unplug the light, charger and cable once the battery is fully charged.

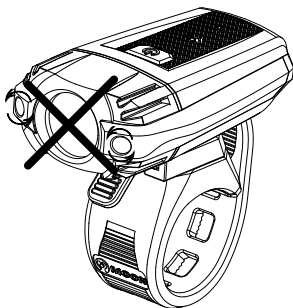

**CAUTION:** When riding at night, please follow the guidelines below:

\*Carrying a flash light is recommended.

\*Use caution when handling, the light may get hot.

\*Unplug the headlight if no use.

\*Unplug connector by the plug, never by the cable.

\*Do not dismantle the headlight and battery case.

\*Provide sufficient airflow to the headlight for cooling during use.

\*Do not control any part of the system under water.

\*Do not look directly at light.

\*Do not leave the light on and unattended.

\*Keep headlight away from fire and combustible materials.

\*Do not store head unit when hot or straightway after use.

\*Unplug the USB cable when fully charged.

\*This light is for bicycle use only.



## SIMPLE PROBLEMS ANALYSIS AND SOLUTION

### 1. Problem: The light is not on

Solution: Check if the battery still has power

Check if the power button is pressed hard

## RUN TIME

mode	Lumen	runtime	 BLUE	 Green	 Red	weight	charge time
Over drive	250	Up to 1 hour 30 mins					
High	130	Up to 2 hours 55 mins					
Standard	60	Up to 6 hours 45 mins	100 % - 60 %	60 % - 20 %	20 % - 0 %	65.7g	2 hours
Flashing	130	Up to 5 hours 40 mins					
Strobe	130	Up to 5 hours 40 mins					

\* Charge time dependent on wall charger or computer

## HOW TO CHARGE BATTERY

**Attention:** If you do not use the battery for a long time, be sure to make it fully recharge every 3 months before storing again. Please keep the battery in cool and dry place when storing. Once you start using the light, you'd better keeping it.

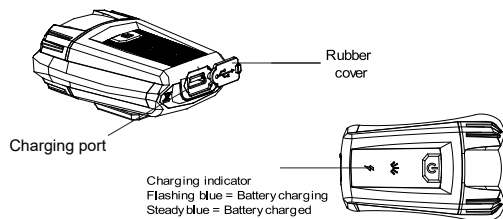

1. Find the charging place at the back of the light.
2. Lift the rubber cover and you'll see the charging port.
3. Plug the USB cable to your computer USB port.
4. Plug the charger cable to the light charger port.
5. The charging indicator shows slow flashing blue when the light is charging, after fully charged it changes to steady.

6. It is normal that the battery may get high temperatures during charging (up to 104°F/40°C), as the chemical in battery is in reaction. If the battery is not drained completely before charging, it may also get warm.

7. Several factors can influence the battery's durability: type of cell strain, the maintenance routine, the temperature and etc. Normally speaking, the higher the battery capacity, the longer the burn time.

8. The battery capacity may become ineffective about 80% of its value after 300-500 charge/discharge cycles. The battery can may 3 years life span under good care.

9. The battery voltage and capacity decrease apparently at low temperatures, especially near or below ice point. The capacity decreases 5%-10% at freezing (burn time decreases 50%). At -20°C, the capacity decreases 30% (burn time decreases 70%). The battery performance will return normal when the temperate gets up to 70°F/20°C.

The battery will lose around 1% of its capacity per day when you store the battery at normal room temperature. Battery temperate should never exceed 104°F/40°C, it will lose about 5% of its capacity per day.

10. If you donot use the battery for a long time, be sure to make it afully recharge every 3 months before storing again. Please keep the battery in cool and dry place when storing.

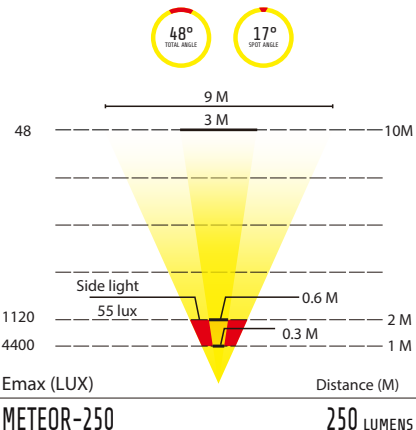

## WARRANTY

MOON warrants to the original purchaser of this product that the product is free from defects in material and workmanship for a period of one year. This warranty does not apply to damage due to heat, physical damage resulting from abuse, neglect, improper repair, improper fit, or alterations of the fixture. This warranty is in lieu of all other agreements and warranties, general or specific, express or implied and no representative or person is authorized to assume liability on behalf of MOON in connection with the sale and use of this product.

MOON reserves the right to request the return of any product submitted for warranty consideration. All customers should contact the local dealer or regional distributor for warranty service.

To make a claim, first call local dealer or regional distributor. Some issues may be resolved upon the initial call. If return of the product is necessary, please refer to the following instructions:

\*We recommend that items be sent by a traceable method (such as FedEx or UPS). MOON is not responsible for lost or misdirected packages.

\*Please include your full contact information (name, address, phone number, and email [if applicable]), and a description of the issue.

\*Address items to: local dealer or regional distributor

What is not covered: MOON Lights are covered by a ONE YEAR LIMITED WARRANTY from the date of purchase. This covers the lights and cables only. It does not cover the battery or battery internals.

Batteries are covered by 120 days warranty.

For more information please contact us at [cs@moon-sport.com](mailto:cs@moon-sport.com).