

HELIX SENSE 450

MANUAL

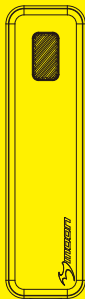

The light is locked for shipment, refer to OPERATION instruction to unlock. Read this manual carefully before using and keep for future reference. Visit www.moon-sport.com for manual updates.

CONTENTS

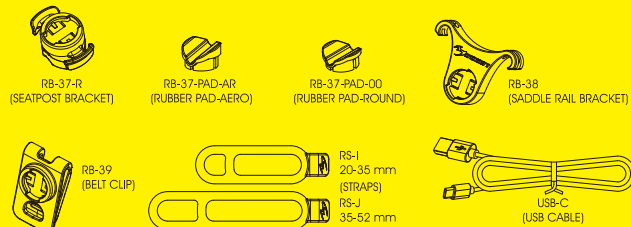

MOUNTING

SEATPOST MOUNTING

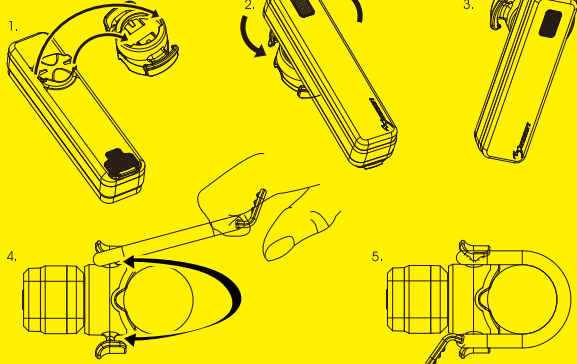

SADDLE RAIL MOUNTING

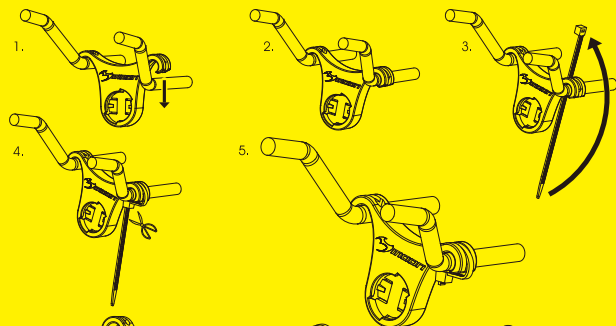

BELT CHIP MOUNTING

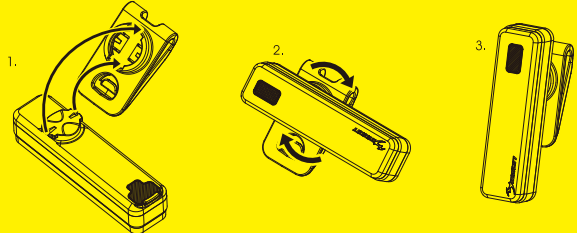

WARNING

Understand country lighting laws and regulations before use.
Do not shine light directly into eyes.
Do not mount near wireless computer.
Do not blind the oncoming vehicles. Always adjust the angle downward.
Do not submerge the light into water.
Keep light in cool and dry place when storing.

WARRANTY

MOON lights are covered by a ONE YEAR LIMITED WARRANTY while MOON batteries are covered by 120 days warranty from the date of purchase. This warranty covers the defects in material and workmanship only with proof of purchase. Please contact original dealer for warranty service. For lights bought on MOON website, please contact cs@moon-sport.com for help.

ONLINE WARRANTY REGISTRATION

Visit www.moon-sport.com for online warranty registration.

OPERATION

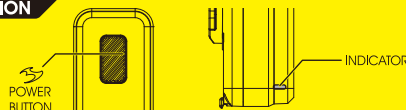

ON / OFF : Press 1s
MODE SELECT : Click
STEADY / FLASH : Double Click
SENSE MODE : 1. Power off
2. Press 3s:



LOCK / UNLOCK : 1. Power off
2. Press 6s: Locked / Unlocked
* Lock and prevent the light turned on accidentally.

VARIABLE LUMEN SYSTEM

1. Select the desired mode.
2. Press and hold to set lumen.
3. Release when the desired lumen is reached.

* Light flashes twice when either the MAX or MIN lumen level is reached.

* **RESTORE DEFAULT MODE:** 1. Power off
2. Press 10s: BLUE FLASH 3 TIMES

MODE MEMORY

*The light resumes the previous mode upon next usage.

AUTO SAFE MODE

Quick Flash

When the battery gets low, the light automatically enters the safe mode that reduces the light output and extend **1.5 hours runtime**.

* *When the light is in the safe mode, all other functions will be temporarily deactivated.

CHARGING

1. Power off / 2. Plug USB-C cable into USB-C port / 3. Unplug after fully charged

* Do not charge over 5V. / * Keep away from flammable objects while charging.

INDICATOR

BLUE Low battery (Slow Flash) / BLUE Auto safe (Quick Flash) / BLUE Charging (Slow Flash) / BLUE Fully Charged * 2:30hrs

SENSE OPERATION

BRIGHTNESS SENSING

The built-in light sensor automatically switches between the NIGHT or DAY time mode.

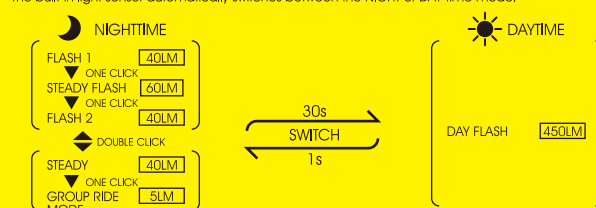









MOTION SENSING

Braking Automatically turns brighter or steady lumen when braking.

Parking When no motion is detected.



RUNTIME

SENSE MODE						DAYTIME		
NIGHTTIME								
DEFAULT		VLS						
ANSI FL1	 LUMEN	 H:MIN	 LUMEN	 H:MIN	 BRAKE SIGNAL	 450 DAYFLASH	 8:00	
FLASH 1	40	48:00	250 +10	9:30 75:00	✓			
STEADY FLASH	5+60	15:00	250 +10	5:00 25:00	✓			
FLASH 2	40	20:00	250 +10	3:30 54:00	✓			
STEADY	40	4:30	80 +5	1:30 24:00	✓			
GROUP RIDE MODE	5	24:00	80 +5	1:30 24:00	✓			

* The stated runtime of each mode includes the BRAKE SIGNAL is enabled 60 times/hour.
* It depends on how many time the BRAKE SIGNAL is used, the actual runtime may vary.

ANSI FL1	STANDARD MODE			
	DEFAULT		VLS	
LUMEN	H:MIN	LUMEN	H:MIN	
DAY FLASH	450	11:00	***	***
STEADY FLASH	5+60	20:00	250 +10	6:30 35:00
FLASH	40	26:00	250 +10	5:00 100:00
STEADY	80	2:15	80 +5	2:15 30:00
GROUP RIDE MODE	5	30:00	80 +5	2:15 30:00